

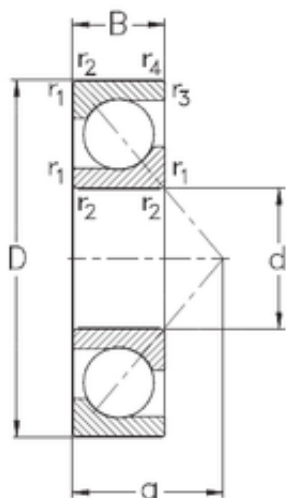

BEARING CORP. OF AMERICA



100 mm x 180 mm x 34 mm NKE 7220-BECB-MP angular contact ball bearings

Bearing No. 7220-BECB-MP

Size	100x180x34 mm
Bore Diameter	100 mm
Outer Diameter	180 mm
Width	34 mm
d	100 mm
D	180 mm
B	34 mm
C	34 mm
Angle (°)	40 °
a	76 mm
r1 min.	2,1 mm
r2 min.	2,1 mm
r3 min.	1,1 mm
r4 min.	1,1 mm
Weight	3,4 Kg
Basic dynamic load rating (C)	136 kN
Basic static load rating (C0)	114 kN

7220-BECB-MP Bearing 2D drawings and 3D CAD models