

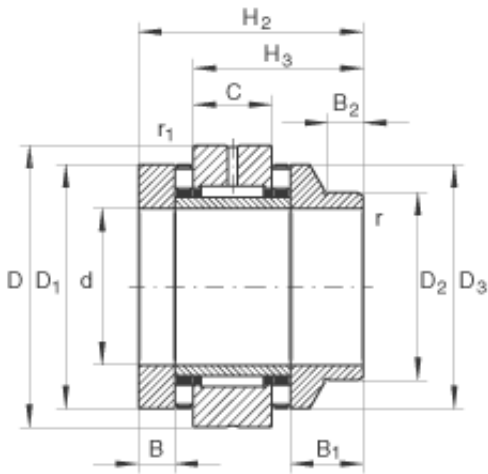

BEARING CORP. OF AMERICA

20 mm x 52 mm x 10 mm INA ZARN2052-L-TV complex bearings

Bearing No. ZARN2052-L-TV



ZARN2052-L-TV Bearing 2D drawings and 3D CAD models

Size	20x52x60 mm
Bore Diameter	20 mm
Outer Diameter	52 mm
Width	60 mm
d	20 mm
D	52 mm
H ₂	60 mm
B	10 mm
B ₁	24 mm
B ₂	11 mm
C	16 mm
D ₁	42 mm
D ₂	30 mm
D ₃	40 mm
D _{a max}	43 mm
d _{a min}	28 mm
H ₃	45 mm
r _{1 min}	0,6 mm
r _{min}	0,3 mm
m	0,46 kg / Weight
C _a	33500 N / Dynamic load rating (axial)
C _{0a}	76000 N / Static load rating (axial)



BEARING CORP.OF AMERICA

C_r	14900 N / Dynamic load rating (radial)
C_{0r}	22400 N / Static load rating (radial)
$n_{G\ OI}$	7000 1/min / Limiting speed for oil lubrication (valid only with adequate oil cooling)
$n_{G\ Fett}$	2000 1/min / Limiting speed for grease lubrication
M_{RL}	0,5 Nm / Bearing frictional torque
C_{aL}	1800 N/ μ m / Axial rigidity
C_{kL}	230 Nm/mrad / Tilting rigidity
M_m	0,683 kg x cm ² / Mass moment of inertia for rotating inner ring
	1 μ m / Axial runout (The axial runout data for screw drive bearing arrangements are based on the rotating inner ring)
	ZMA20/38 / Designation of recommended INA locknut
Category	Ball Bearings
Inventory	0.0
Manufacturer Name	SCHAEFFLER GROUP
Minimum Buy Quantity	N/A
Weight / Kilogram	0.551
EAN	4012802552720
Product Group	B00234